

PUMPER BODY

Medium Aluminum 2nd Gen Pumper

CHASSIS

Enforcer Chassis

CHASSIS AXLE, FRONT, CUSTOM

19,500 lb TAK-4 Axle

AXLE, REAR

24,000 lb Meritor Axle

ENGINE

510 HP Paccor MX13 Engine

TRANSMISSION

Allison 6th Gen, 4000 EVS P

BUMPER

19" Extended Stainless Steel

CAB

7010 Enforcer Cab

BODY

TOTAL TANK CAPACITY

750 Gallon Poly Tank

WATER CAPACITY

730 Gallons of Water

FOAM CELL

20 Gallon Foam Cell

COMPT, PUMPER, REAR

30.75" FF RollUp Rear Compt

COMPT, PUMPER, LEFT SIDE

152" RollUp Full Height Front & Rear FDLER

COMPT, PUMPER, RIGHT SIDE

152" RollUp Full Height & Depth Front & Rear BIB

FIRE SUPPRESSION PUMPHOUSE

38" Control Zone Side Mount

PUMP

1500 GPM Waterous CSU

CROSSLAYS, 1.50"

1.50" CrossLays Not Required

CROSSLAYS, 2.50"

(1) 2.50" Standard Capacity

SPEEDLAYS

(2) 1.50" Standard Capacity

GENERATOR

Generator Not Required

FOAM SYSTEM

Husky 3 Single Agent Foam System

SAFETY

Side Roll and Frontal Impact Protection

NOTE
DIMENSIONS SHOWN ARE APPROXIMATE AND ARE SUBJECT TO MINOR DEVIATIONS AS MAY OCCUR OR BE NECESSARY IN CONSTRUCTION. MINOR DETAILS NOT SHOWN.

- ONE 1.50" OUTLET WITH 2.00" PIPING AND SWIVEL LOCATED IN CENTER BUMPER TRAY
- SHOULDER RECEPTACLE WITH KUSSMAUL AUTO-EJECT AND COVER LOCATED ON DRIVER'S SIDE OF THE CAB
- BATTERY CHARGER LOCATED PER ORDER
- ONE ADJUSTABLE SHELF WITH SPECIAL SIDE HEIGHT LOCATED PER ORDER
- SEVEN ADJUSTABLE SHELVES LOCATED PER ORDER
- ONE FLOOR MOUNTED SLIDE-OUT TRAY W/ SIDE SLIDES LOCATED PER ORDER
- ONE CTECH FOUR DRAWER ASSEMBLY LOCATED PER ORDER
- ONE ZIGZAG BRACKET LOCATED PER ORDER
- PEGBOARD MOUNTED ON THE BACK WALL PER ORDER

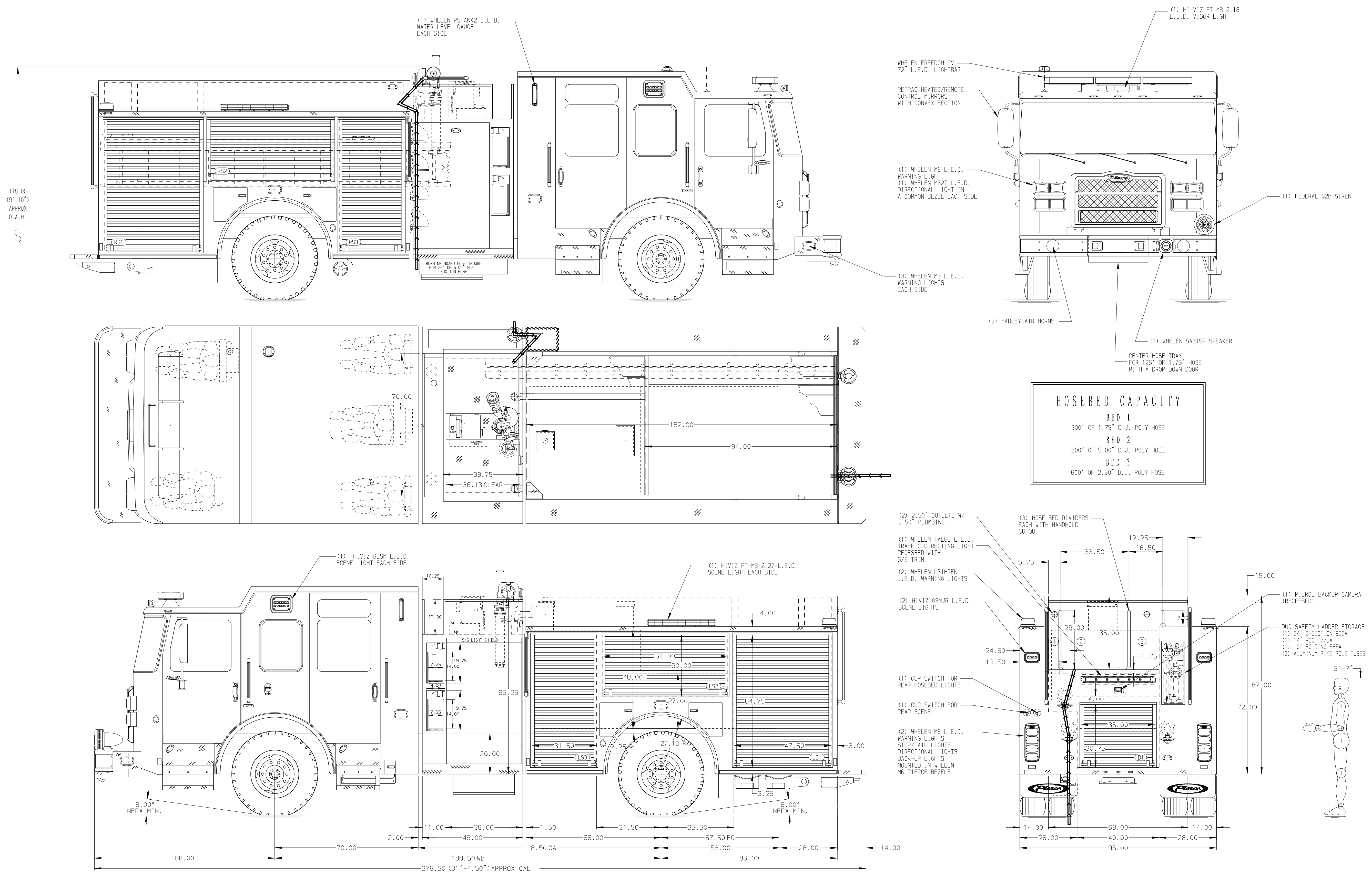

HOSEBED CAPACITY	
BED 1	300' OF 1.75" D.J. POLY HOSE
BED 2	800' OF 5.00" D.J. POLY HOSE
BED 3	600' OF 2.50" D.J. POLY HOSE

		JOB NO.	41953
		SCALE	DATE
Pierce Pumper Approval Drawing Anoka-Champlin Fire Department		DRAWN BY	LST 04MAR24
		CHECKED BY	MMF 04MAR24
DWG NO. 41953AD		SHEET SIZE	SHEET NO.
		D	1 OF 1

REV	DATE	BY	CH	ENFORCER
17JUN24	LST	CLM		PIERCE
02MAY24	MMF	CLM		MODEL