

Pumper, PUC BODY

Pumper, PUC, Aluminum

CHASSIS

Enforcer Chassis, PUC-NG

CHASSIS AXLE, FRONT, CUSTOM

18,000 Lb Dana Axle

AXLE, REAR

27,000 Lb Dana Axle

ENGINE

450 HP Cummins L9 Engine

TRANSMISSION

Allison 6th Gen, 3000 EVS P

BUMPER

19" Extended Painted Steel

CAB

7010 Enforcer Cab, PUC

BODY

WATER TANK

750 Gallon Poly Water Tank

COMPT, PUMPER, REAR

33.50" FF RollUp Rear Compt w/Tailboard, PUC

COMPT, PUMPER, DRIVER SIDE

177" RollUp Full Height & Depth Front & Rear, PUC

COMPT, PUMPER PASS. SIDE

177" RollUp Full Height & Depth Front & Rear, PUC

FIRE SUPPRESSION PUMPHOUSE

Control Zone, PUC

PUMP

1500 GPM Pierce PUC

CROSSLAYS, 1.50"

(2) 1.50", Full Width Poly Trays, 200"

CROSSLAYS, 2.50"

2.50" CrossLay Not Required

GENERATOR

Generator Not Required

Foam System

Foam System Not Required

Foam Cell

Foam Cell Not Required

NOTE

DIMENSIONS SHOWN ARE APPROXIMATE AND ARE SUBJECT TO MINOR DEVIATIONS AS MAY OCCUR OR BE NECESSARY IN CONSTRUCTION. MINOR DETAILS NOT SHOWN.

- ONE 1.50" OUTLET WITH 2.00" PIPING AND SWIVEL LOCATED ON TOP BUMPER RIGHT SIDE
- BLUE SEA SHORELINE RECEPTACLE LOCATED ON DRIVER SIDE OF THE CAB
- AIR INLET/OUTLET WITH DISCONNECT COUPLING ON THE DRIVER SIDE PUMP PANEL
- BATTERY CHARGER LOCATED DRIVER SIDE BEHIND SEAT
- FIVE ADJUSTABLE SHELVES IN COMPARTMENTS PER SHOP ORDER
- ONE FLOOR MOUNTED SLIDE-OUT TRAY IN COMPARTMENT PER SHOP ORDER
- ONE SPECIAL-SIZE ADJUSTABLE SHELF LOCATED IN COMPARTMENT PER SHOP ORDER
- ONE CTECH FOUR DRAWER ASSEMBLY LOCATED IN COMPARTMENT PER SHOP ORDER
- ONE SWING-OUT TOOLBOARD LOCATED IN COMPARTMENT PER SHOP ORDER
- TWO PEGBOARDS MOUNTED ON BACK WALL IN COMPARTMENT PER SHOP ORDER
- AUTOMATIC TIRE CHAINS
- OIL DRY HOPPER WITH 200 LBS. OF OIL DRY ABSORBENT LOCATED PER SHOP ORDER

- ONE 1.50" OUTLET WITH 2.00" PIPING AND SWIVEL LOCATED ON TOP BUMPER RIGHT SIDE
- BLUE SEA SHORELINE RECEPTACLE LOCATED ON DRIVER SIDE OF THE CAB
- AIR INLET/OUTLET WITH DISCONNECT COUPLING ON THE DRIVER SIDE PUMP PANEL
- BATTERY CHARGER LOCATED DRIVER SIDE BEHIND SEAT
- FIVE ADJUSTABLE SHELVES IN COMPARTMENTS PER SHOP ORDER
- ONE FLOOR MOUNTED SLIDE-OUT TRAY IN COMPARTMENT PER SHOP ORDER
- ONE SPECIAL-SIZE ADJUSTABLE SHELF LOCATED IN COMPARTMENT PER SHOP ORDER
- ONE CTECH FOUR DRAWER ASSEMBLY LOCATED IN COMPARTMENT PER SHOP ORDER
- ONE SWING-OUT TOOLBOARD LOCATED IN COMPARTMENT PER SHOP ORDER
- TWO PEGBOARDS MOUNTED ON BACK WALL IN COMPARTMENT PER SHOP ORDER
- AUTOMATIC TIRE CHAINS
- OIL DRY HOPPER WITH 200 LBS. OF OIL DRY ABSORBENT LOCATED PER SHOP ORDER

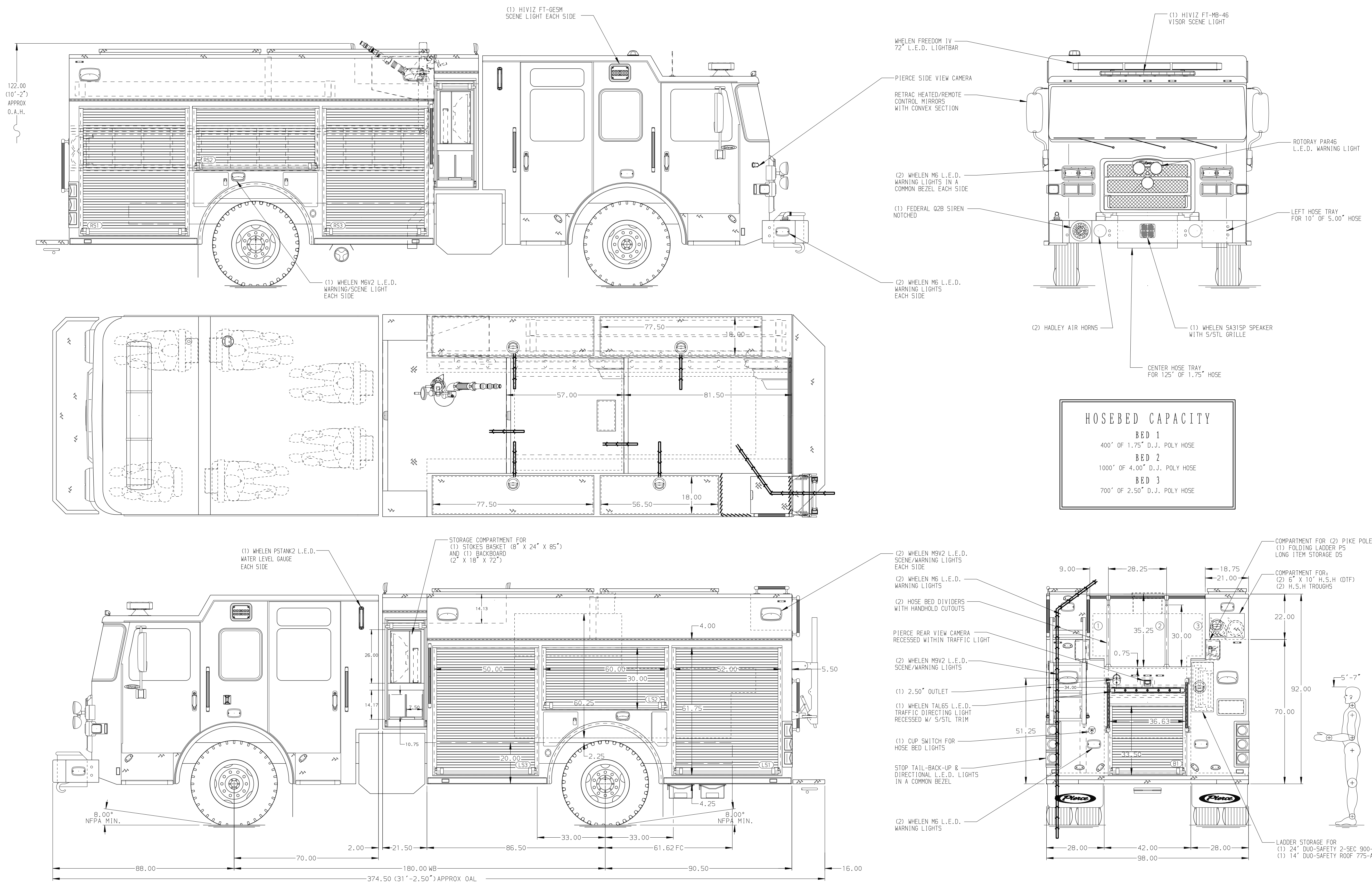

HOSEBED CAPACITY	
BED 1	400' OF 1.75" D.J. POLY HOSE
BED 2	1000' OF 4.00" D.J. POLY HOSE
BED 3	700' OF 2.50" D.J. POLY HOSE

		JOB NO.	40832
		SCALE	DATE
Pierce MANUFACTURING INC.		TITLE	Pierce PUC Pumper Approval Drawing
		FOR	City of Hendersonville
PIERCE		CHECKED BY	12APR24
		DWG NO.	40832AD
ENFORCER		SHEET SIZE	SHEET NO.
		D	1 OF 1