

BODY	WATER TANK
107' ASL Aluminum Body	500 Gallon Poly Water Tank
COMPT, LEFT SIDE FRONT	Foam System
Full Height RollUp Forward	Husky 12 Single Agent Foam System
COMPT, LEFT SIDE REAR	Foam Cell
Full Height RollUp Rearward	30 Gallon Foam Cell, Reduced Water
COMPT, RIGHT SIDE FRONT	
Full Height RollUp Forward	
COMPT, RIGHT SIDE REAR	
Full Height RollUp Rearward	

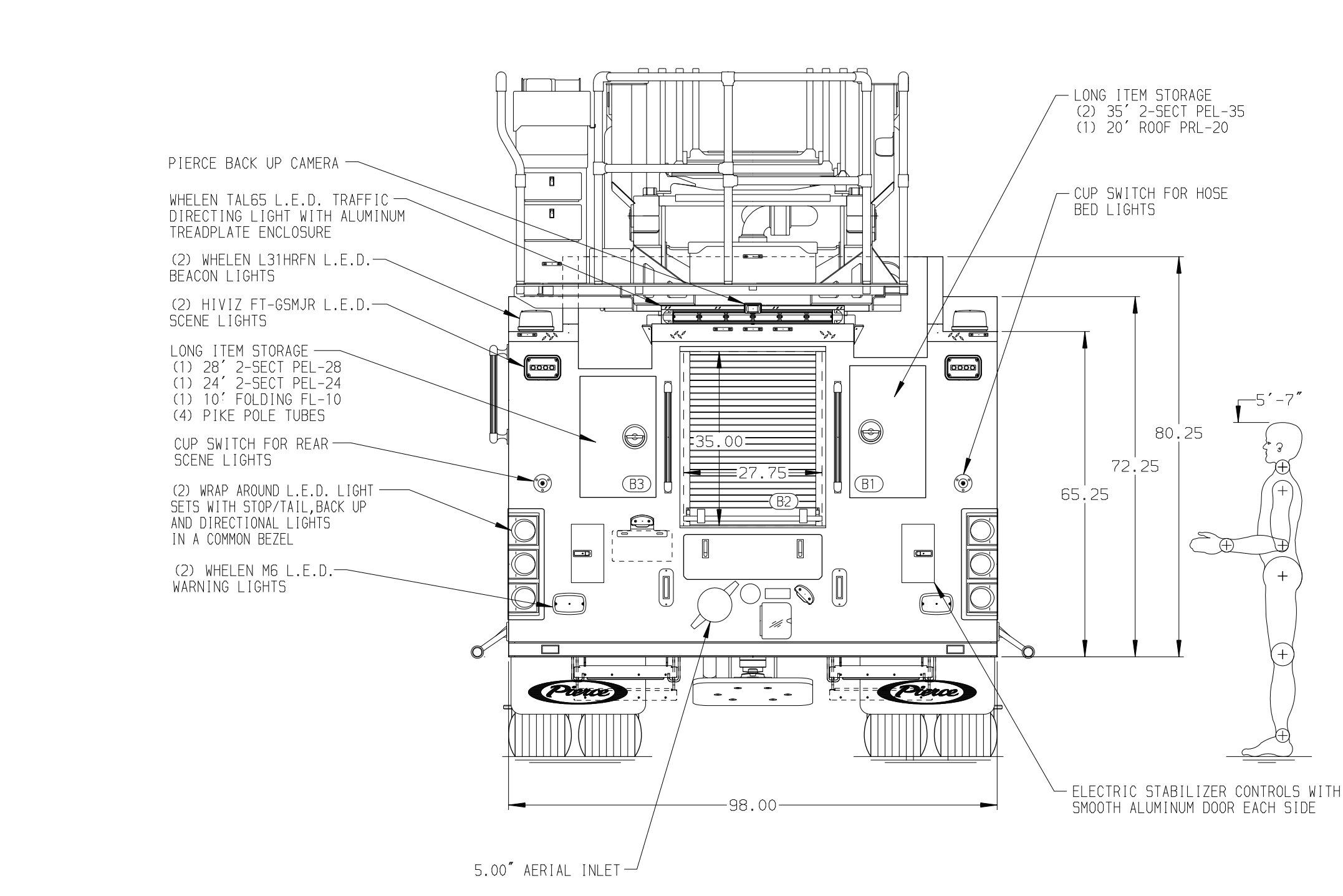
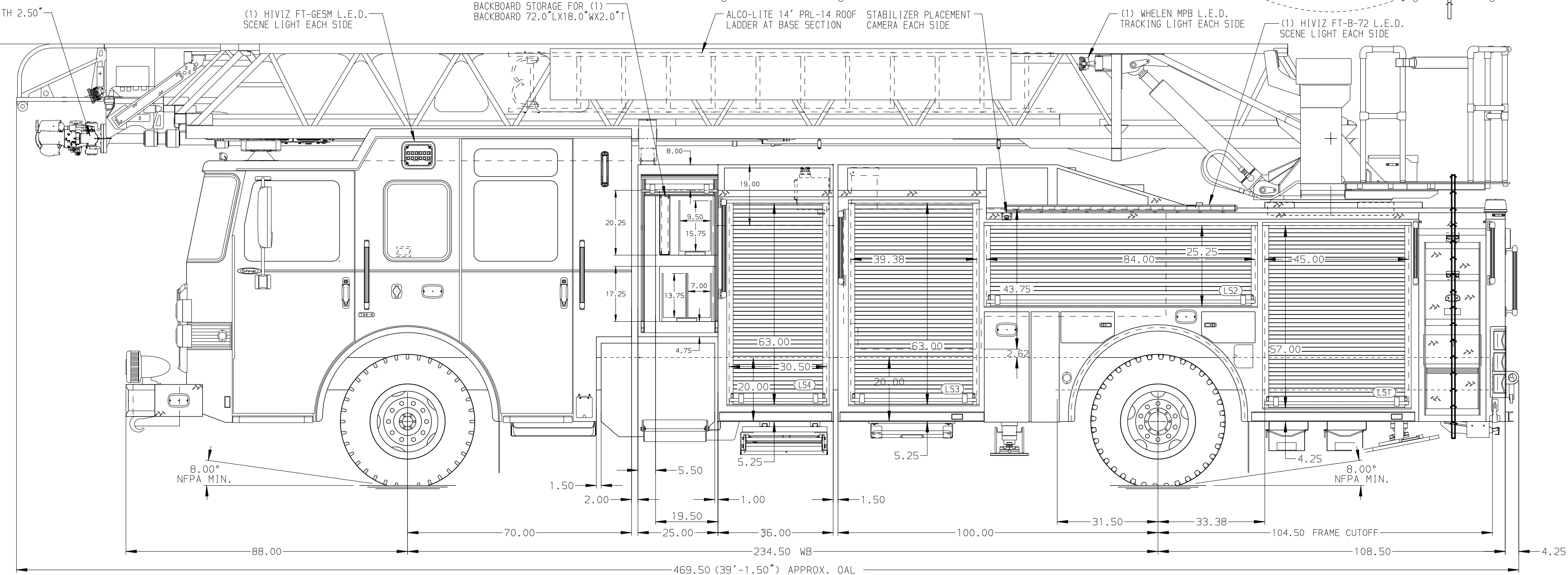

CHASSIS	CAB	AXLE, FRONT, CUSTOM	TRANSMISSION	PUMPHOUSE	CROSSLAYS, 1.50"	SPEEDLAYS	SAFETY	Pierce MANUFACTURING INC.		JOB NO.
Enforcer Chassis	7010 Enforcer Notched Cab	24,000 Lb TAK-4 Axle	Allison 6th Gen, 4500 EV5	Control Zone, PAL/PAP PUC PUMP	(2) 1.50", Poly Trays, 200'	Speedlays Not Required	Side Roll and Frontal Impact Protection	Pierce MANUFACTURING INC.		40698
ENGINE	BUMPER	AXLE, REAR			CROSSLAYS, 2.50"	GENERATOR		TITLE		SCALE
510 HP Paccar MX13 Engine	19" Stainless Steel	33,500 Lb Meritor Axle			(1) 2.50", Poly Tray, 200'	Generator Not Required		FOR		DATE
NOTE								FOR		
1. SHORELINE RECEPTACLE WITH KUSSMAUL SUPER AUTO-EJECT LOCATED ON DRIVER SIDE OF THE CAB 2. AIR INLET WITH DISCONNECT COUPLING LOCATED FORWARD IN THE DRIVER SIDE STEPPED WELL 3. BATTERY CHARGER LOCATED BEHIND DRIVERS SEAT 4. BATTERY CHARGE INDICATOR DISPLAYED THROUGH WINDOW BEHIND DRIVERS SEAT 5. ONE 1.50" OUTLET WITH 2.00" PIPING AND SWIVEL LOCATED IN CENTER BUMPER TRAY 6. NINE ADJUSTABLE SHELVES LOCATED IN COMPARTMENTS PER ORDER 7. FOUR FLOOR MOUNTED SLIDE-OUT TRAYS LOCATED IN COMPARTMENTS PER ORDER 8. ONE TOOL GRID SYSTEM LOCATED IN COMPARTMENT PER ORDER 9. TWO BACK WALL MOUNTED PEGBOARDS LOCATED IN COMPARTMENTS PER ORDER 10. LIMITED RETRACTION NOT REQUIRED 11. TECNIO RUNG LIGHTING AT AERIAL DEVICE 12. 1500 GPM HIGH FLOW WATERWAY 13. WIRELESS CAMERA SYSTEM AT AERIAL TIP 14. REMOTE AERIAL TIP CONTROLS 15. ADDITIONAL BREATHING AIR OUTLET AT AERIAL TIP								DRAWN BY		
								ANZ		31JAN24
19APR24								MODEL		
REV								DWG NO.		40698AD
BY								SHEET NO.		1 OF 1
CH								SHEET SIZE		D