

PUMPER BODY

Medium Aluminum 2nd Gen Pumper

CHASSIS

Enforcer Chassis

CHASSIS AXLE, FRONT, CUSTOM

22,800 Lb TAK-4 Axle

AXLE, REAR

27,000 Lb Meritor Axle

ENGINE

510 HP Paccor MX13 Engine

TRANSMISSION

Allison 6th Gen, 4000 EVS P

BUMPER

19" Extended Pointed Steel

CAB

7010 Enforcer Cab

BODY

TOTAL TANK CAPACITY

1020 Gallon Poly Tank

WATER CAPACITY

1000 Gallons of Water

FOAM CELL

20 Gallon Foam Cell

COMPT, PUMPER, REAR

37.75" FF RollUp Rear Compt

COMPT, PUMPER, LEFT SIDE

152" RollUp Full Height Front & Rear FDLR

COMPT, PUMPER, RIGHT SIDE

152" RollUp Full Height Front & Rear FDLR

FIRE SUPPRESSION PUMPHOUSE

45" Control Zone Side Mount

PUMP

1500 GPM Waterous CSU

CROSSLAYS, 1.50"

(2) 1.50" Standard Capacity

CROSSLAYS, 2.50"

(1) 2.50" Standard Capacity

SPEEDLAYS

SpeedLays Not Required

GENERATOR

Generator Not Required

FOAM SYSTEM

Foam Pro 1600 Foam System

SAFETY

Side Roll and Frontal Impact Protection

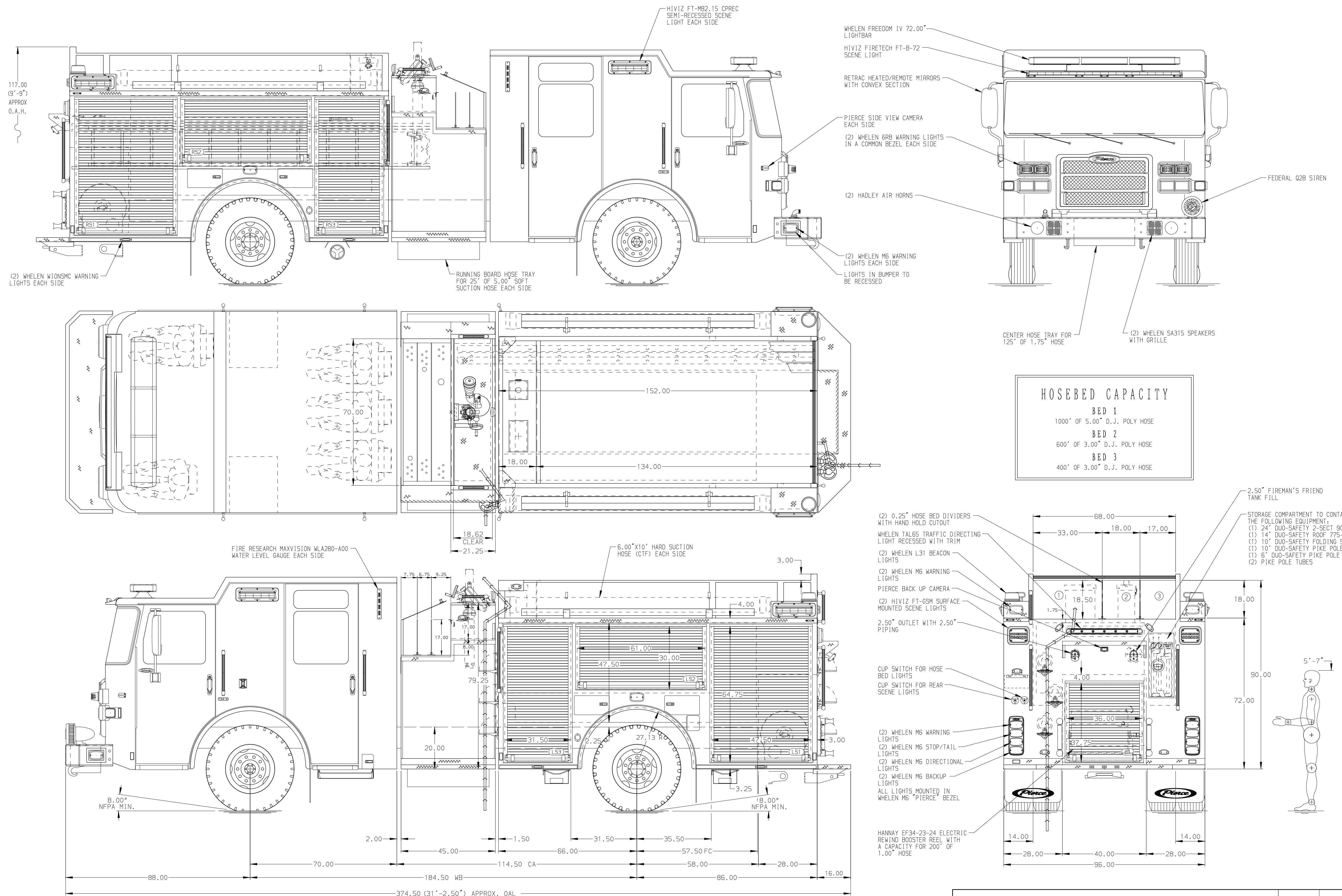

NOTE
DIMENSIONS SHOWN ARE APPROXIMATE AND ARE SUBJECT TO MINOR DEVIATIONS AS MAY OCCUR OR BE NECESSARY IN CONSTRUCTION. MINOR DETAILS NOT SHOWN.

- AIR INLET/OUTLET WITH DISCONNECT FITTING LOCATED IN DRIVER SIDE STEP WELL
- BATTERY CHARGER LOCATED IN LEFT SIDE EMS COMPARTMENT
- BATTERY CHARGER INDICATOR LOCATED ON DRIVER SIDE SEAT RISER
- JUMPER STUDS LOCATED IN DRIVER SIDE STEP WELL
- 120V BLUE SEA SHORELINE RECEPTACLE WITH AUTO EJECT LOCATED ON DRIVER SIDE OF CAB
- ONE FULL WIDTH/DEPTH ADJUSTABLE SHELF WITH SIDES LOCATED IN COMPARTMENT-L51, L53, R51, R53
- ONE FLOOR MOUNTED SLIDE-OUT TRAY WITH SIDES LOCATED IN COMPARTMENT-L51, L53, R51, R53
- ONE SWING-OUT TOOLBOARD WITH PEGBOARD PATTERN LOCATED IN COMPARTMENT-L52, R52

REV	DATE	BY	CH	ENFORCER
22JUL24	SJM	CHR		
24MAY24	BST	CHR		

		JOB NO.	40111
		SCALE	DATE
TITLE	Pierce Pumper Approval Drawing		
MAKE	-		
FOR	Bloomington Volunteer Fire Department		
DWG NO.	40111AD		
	CHECKED BY	MMF	SHEET NO.
	DRAWN BY	BST	1 OF 1